

# GRINSTED OVAL and SOUTH CIRCLE OVAL MASTER PLAN

**DRAFT**



## GRINSTED OVAL SOUTH CIRCLE OVAL MASTER PLAN

### Plan Features:

- 1 Bali Memorial.
- 2 Cricket nets - potentially need to be relocated to facilitate club house development. Location TBD.
- 3 Cricket sight screens at both ends of both grounds.
- 4 Grounds name signage.
- 5 Hard stand car parking.
- 6 Improve surface drainage of both cricket tables.
- 7 Improve parking layout and surfacing adjacent to existing club house.
- 8 Lighting to both fields.
- 9 Main access to grounds from Camp Street thereby improving access and traffic flow.
- 10 Permanent ticket booths - location TBD.
- 11 Picnic facilities on lawn area to the south of South Circle to take advantage of lake views.
- 12 Piping of storm water drain coming off Browne Street to improve functionality.
- 13 Power supply - upgrades to better cater for events. Locations TBD.
- 14 Priority removal of large tree adjacent to club house.
- 15 Pump track.
- 16 Re-locatable tiered seating to allow for viewing of rugby or cricket.
- 17 Renovate and upgrade club house to provide improved change room facilities.
- 18 Remove old cricket shed when replacement is built.
- 19 Reservation of site marked "A" for future club house development.
- 20 Score boards - two new multifunction electronic boards, location TBD.
- 21 Shared zone to carry pedestrians through car park.
- 22 Staged removal of aging trees and replacement with species offering optimum shade.
- 23 Storage with sufficient space for multiple users.
- 24 Subsurface drainage and surface improvements to area between ovals.
- 25 Subsurface drainage to outer Grinstead & South Circle Oval.
- 26 Water bottle fill stations - locations TBD.

### PLAN KEY

- |                         |                      |
|-------------------------|----------------------|
| Bali Memorial           | Rugby Union field    |
| Drain to be piped       | Score board          |
| New building            | Sight screen         |
| New trees to be planted | Trees to be removed  |
| Re-locatable seating    | Trees to be retained |
| Cricket nets            | Turf wicket          |

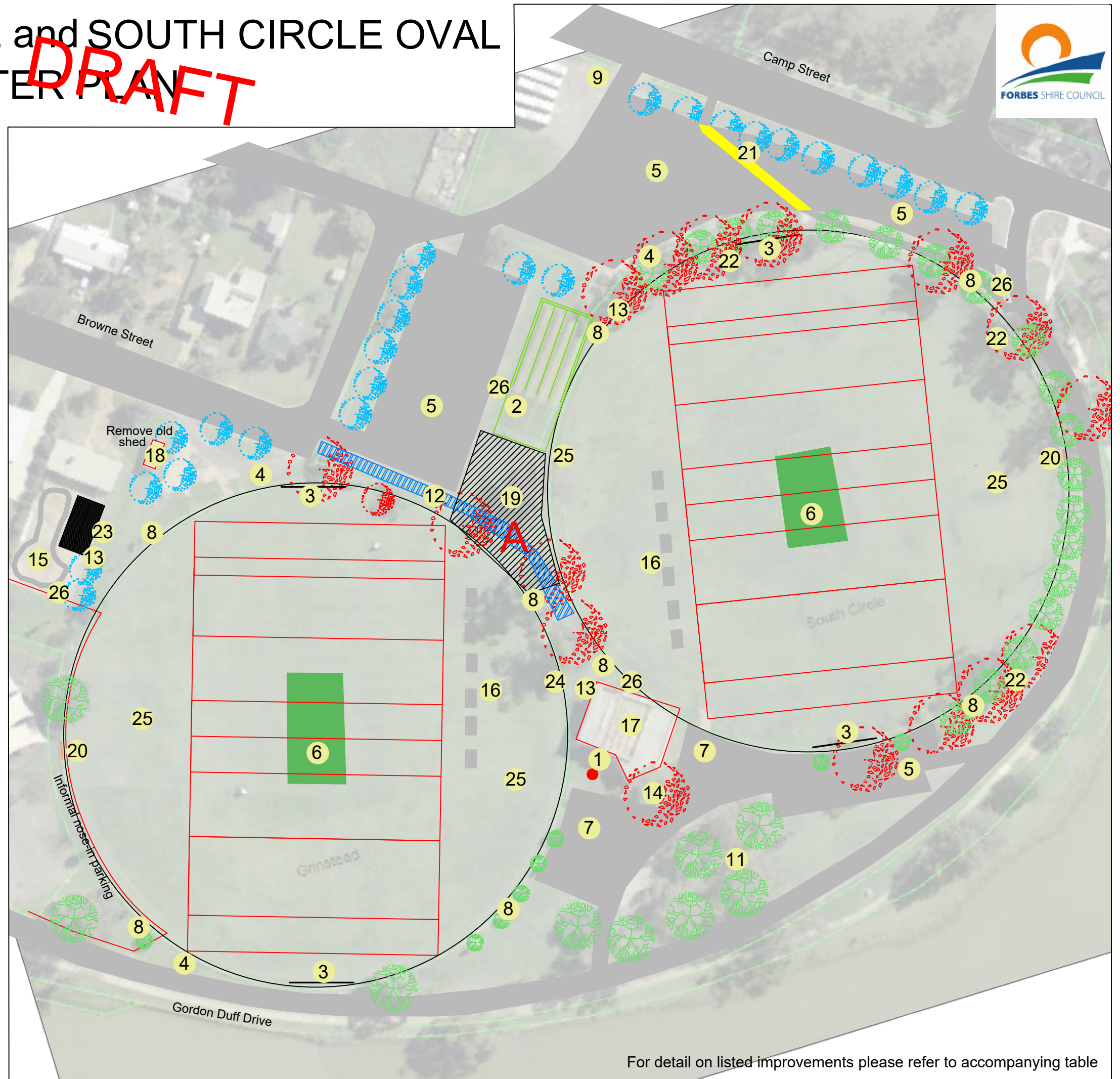

For detail on listed improvements please refer to accompanying table